

SHIMANO®

SHIMANO EUROPA

Industrieweg 24 NL-8071 CT Nunspeetâ Holland
Phone 31-341-272222

SHIMANO AMERICAN CORPORATION

One Holland Irvine CA 92618 U.S.A.
Phone 949-951-5003

Spare parts list for after market.

- You may photocopy this sheet and use it as an order form.
- Sie können dieses Blatt kopieren und als Bestellformular verwenden.
- Vous pouvez photocopier cette feuille et l'utiliser comme bon de commande.
- Dit blad kan gecopieerd en als bestelformulier gebruikt worden.
- Potete fotocopiare questo foglio e usarlo come modulo di commissione.

SHIMANO SORA Dual Control Lever (FLIGHT DECK Compatible)

Dec. 1999

ST-3300

For Double Gear

ST-3303

For Triple Gear

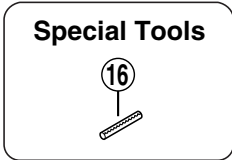
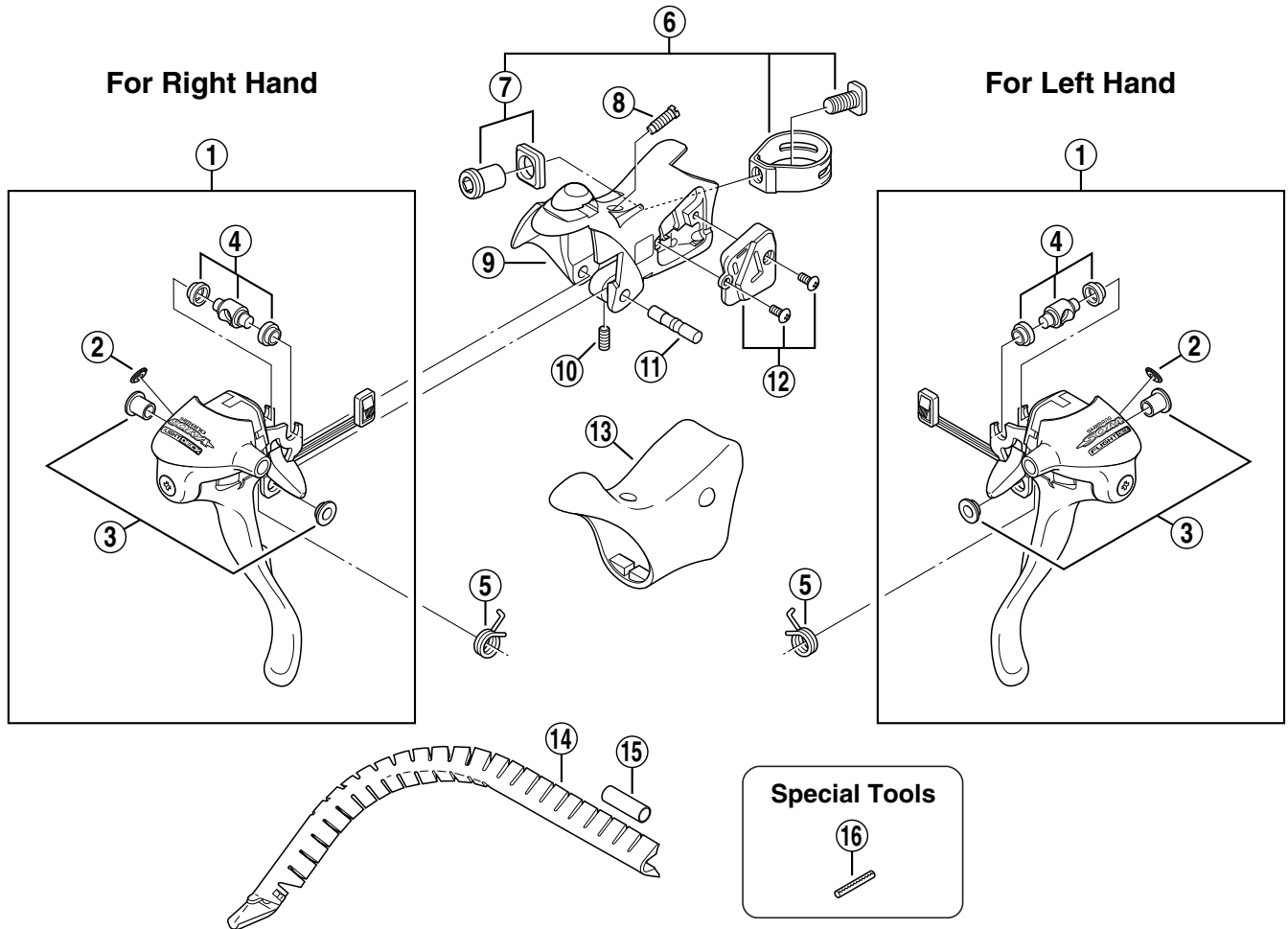

Q'TY	ITEM NO.	SHIMANO CODE NO.	DESCRIPTION
	1	Y-6CU98010	R.H. Main Lever Assembly
		Y-6CU98020	L.H. Main Lever Assembly for Double Gear
		Y-6CU98030	L.H. Main Lever Assembly for Triple Gear
	2	Y-6CU39000	Cap
	3	Y-85Z 98010	Lever Axle Bush Unit
	* 4	Y-6CU98050	Cable Hook Unit
	5	Y-6BD75000	R.H. Return Spring
		Y-6BD74000	L.H. Return Spring
	6	Y-6BD98120	Clamp Band Unit (φ 23.8 mm – φ 24.2 mm)
	7	Y-6BD98130	Clamp Nut & Washer
	8	Y-6CU87000	Grip Adjusting Screw (M4 x 11.6)
	9	Y-6CU89000	R.H. Bracket
		Y-6CU89010	L.H. Bracket for Double Gear
		Y-6CU89020	L.H. Bracket for Triple Gear
	10	Y-6BD76000	Lever Axle Fixing Screw
	11	Y-6BS 84000	Lever Axle
	12	Y-6CT 98080	R.H. Bracket Cap & Fixing Screws (M3 x 6.35)
		Y-6CT 98090	L.H. Bracket Cap & Fixing Screws (M3 x 6.35)
	13	Y-6CU98040	Bracket Covers (Pair)
	14	Y-86B 90010	Outer Cable Guide
	15	Y-877 11000	Outer Cable Joint
	16	Y-130 03100	Return Spring Installation Tool (TL-ST02)