

SHIMANO®

SHIMANO EUROPA
 Industrieweg 24 NL-8071 CT Nunspeetâ Holland
 Phone 31-3412-72222

SHIMANO AMERICAN CORPORATION
 One Holland Irvine CA 92618 U.S.A.
 Phone 949-951-5003

Spare parts list for after market.

- You may photocopy this sheet and use it as an order form.
- Sie können dieses Blatt kopieren und als Bestellformular verwenden.
- Vous pouvez photocopier cette feuille et l'utiliser comme bon de commande.
- Dit blad kan gecopieerd en als bestelformulier gebruikt worden.
- Potete fotocopiare questo foglio e usarlo come modulo di commissione.

SHIMANO 105 Dual Control Lever **ST-5500-C** FLIGHT DECK Compatible

Feb. 1999

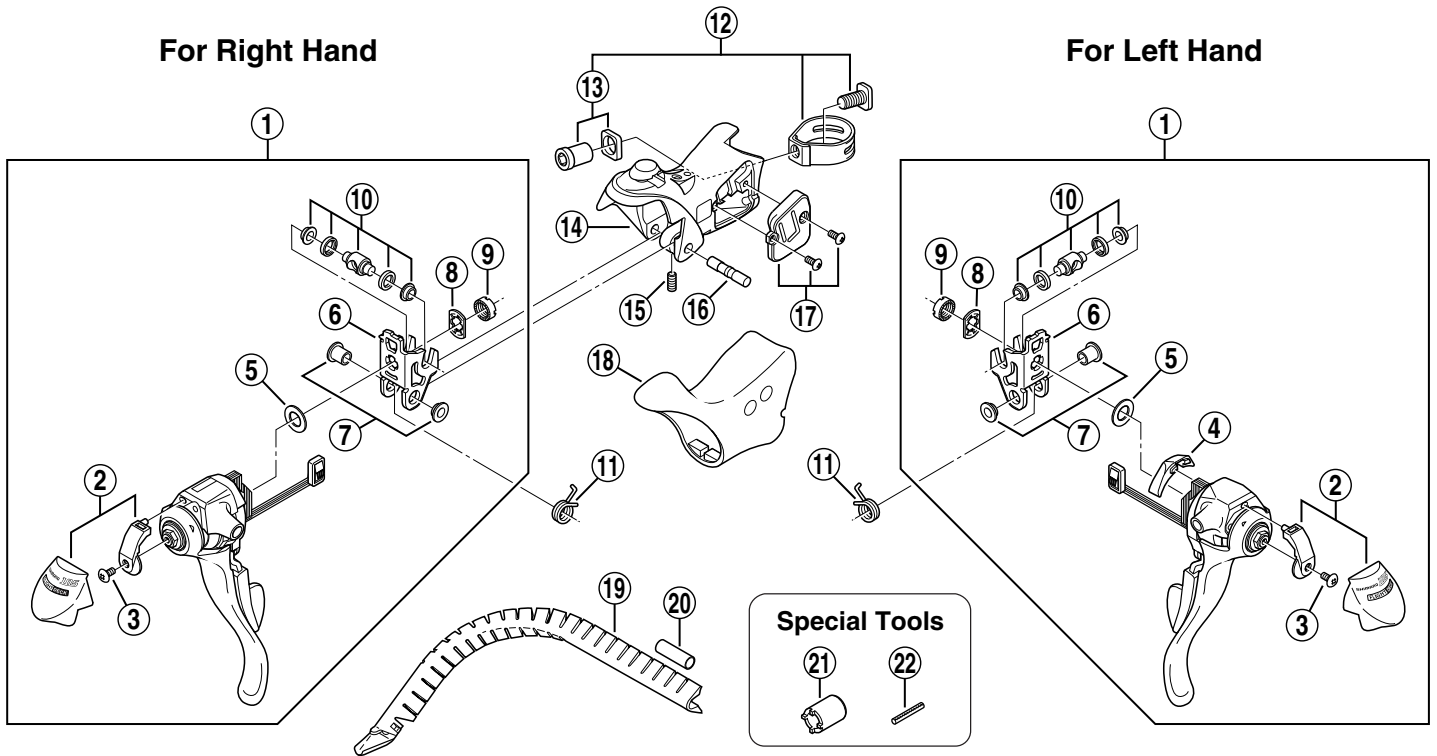

ITEM NO.	SHIMANO CODE NO.	DESCRIPTION
1	Y-6B9 98010	R.H. Main Lever Assembly
	Y-6B9 98020	L.H. Main Lever Assembly
2	Y-6B9 98030	R.H. Name Plate & Front Cover
	Y-6B9 98040	L.H. Name Plate & Front Cover
3	Y-6BS 42000	Front Cover Fixing Screw (M3 x 6)
4	Y-6BS 71100	L.H. Rear Cover
5	Y-6BS 74000	Adapter Spacer
6	Y-6B4 01000	R.H. Adapter
	Y-6B4 51000	L.H. Adapter
7	Y-85Z 98010	Lever Axle Bush Unit
8	Y-6BD39000	Non-Turn Washer
9	Y-66E 33000	Lock Nut
10	Y-6BD98110	Cable Hook Unit
11	Y-6BD75000	R.H. Return Spring
	Y-6BD74000	L.H. Return Spring
12	Y-6BD98120	Clamp Band Unit (φ23.8 mm – φ24.2 mm)
13	Y-6BD98130	Clamp Nut & Washer
14	Y-6B4 98030	R.H. Bracket
	Y-6B4 98040	L.H. Bracket
15	Y-6BD76000	Lever Axle Fixing Screw
16	Y-6BS 84000	Lever Axle
17	Y-6B9 98050	R.H. Bracket Cap & Fixing Screws (M3 x 6.35)
	Y-6B9 98060	L.H. Bracket Cap & Fixing Screws (M3 x 6.35)
18	Y-6BZ 98090	Bracket Covers (Pair)
19	Y-86B 90010	Outer Cable Guide
20	Y-877 11000	Outer Cable Joint
21	Y-130 03000	Lock Nut Removal Tool (TL-ST01)
22	Y-130 03100	Return Spring Installation Tool (TL-ST02)