

SHIMANO 105 Dual Control Lever

ST-5500-CA FLIGHT DECK Compatible

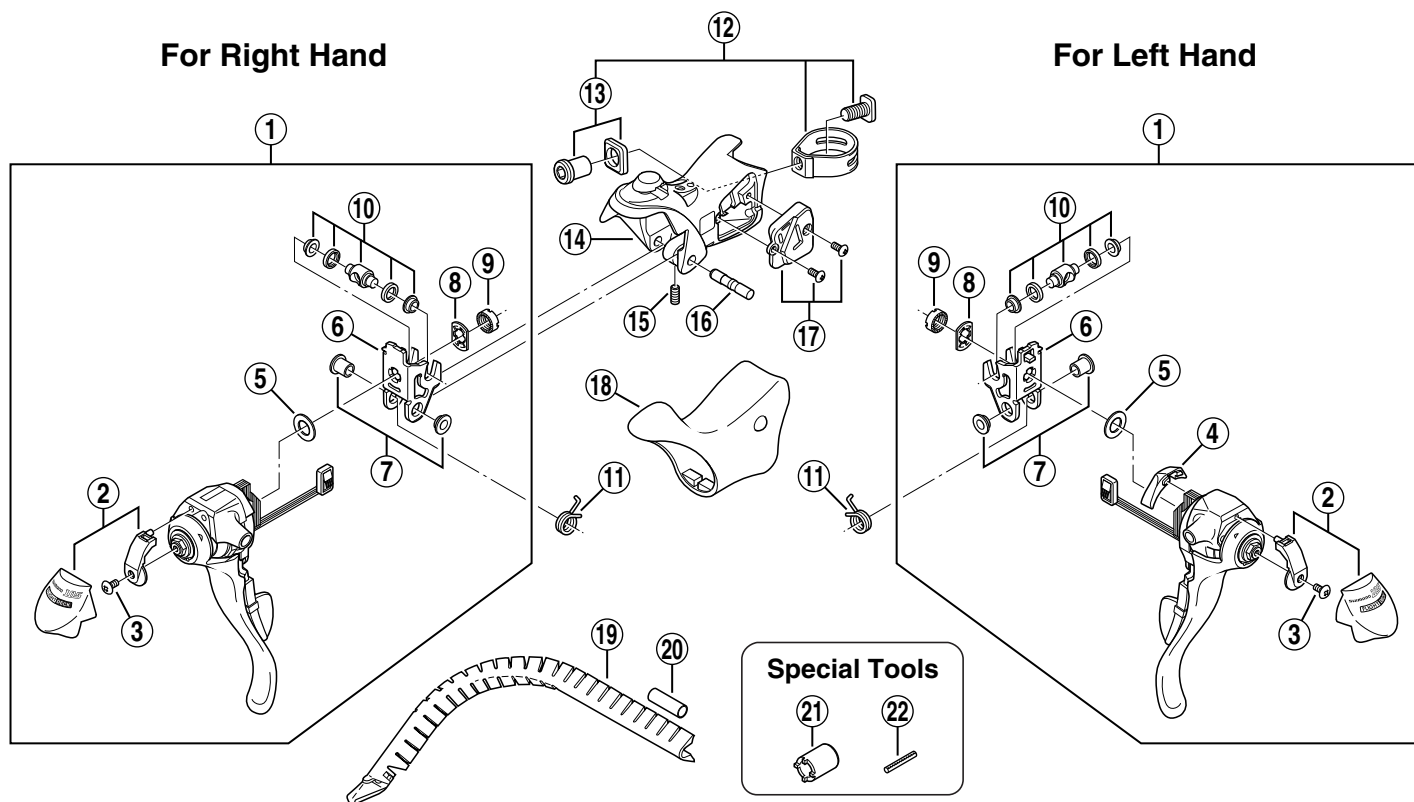

| Q'TY | ITEM NO. | SHIMANO CODE NO. | DESCRIPTION |
|------|----------|------------------|--|
| | 1 | Y-6B9 98070 | R.H. Main Lever Assembly |
| | | Y-6B9 98080 | L.H. Main Lever Assembly |
| * | 2 | Y-6B9 98120 | R.H. Name Plate & Front Cover |
| * | | Y-6B9 98130 | L.H. Name Plate & Front Cover |
| | 3 | Y-6BS 42000 | Front Cover Fixing Screw (M3 x 6) |
| | 4 | Y-6BS 71100 | L.H. Rear Cover |
| | 5 | Y-6BS 74000 | Adapter Spacer |
| | 6 | Y-6CT 03000 | R.H. Adapter |
| | | Y-6CT 03010 | L.H. Adapter |
| | 7 | Y-85Z 98010 | Lever Axle Bush Unit |
| | 8 | Y-6BD39000 | Non-Turn Washer |
| | 9 | Y-66E 33000 | Lock Nut |
| | 10 | Y-6BD98110 | Cable Hook Unit |
| | 11 | Y-6BD75000 | R.H. Return Spring |
| | | Y-6BD74000 | L.H. Return Spring |
| | 12 | Y-6BD98120 | Clamp Band Unit (φ 23.8 mm – φ 24.2 mm) |
| | 13 | Y-6BD98130 | Clamp Nut & Washer |
| | 14 | Y-6B4 98030 | R.H. Bracket |
| | | Y-6B4 98040 | L.H. Bracket |
| | 15 | Y-6BD76000 | Lever Axle Fixing Screw |
| | 16 | Y-6BS 84000 | Lever Axle |
| | 17 | Y-6CT 98080 | R.H. Water-Proof Cap & Fixing Screws (M3 x 6.35) |
| | | Y-6CT 98090 | L.H. Water-Proof Cap & Fixing Screws (M3 x 6.35) |
| | 18 | Y-6B9 98090 | Bracket Covers (Pair) |
| | 19 | Y-86B 90010 | Outer Cable Guide |
| | 20 | Y-877 11000 | Outer Cable Joint |
| | 21 | Y-130 03000 | Lock Nut Removal Tool (TL-ST01) |
| | 22 | Y-130 03100 | Return Spring Installation Tool (TL-ST02) |