

SHIMANO®

SHIMANO EUROPA

Industrieweg 24 NL-8071 CT Nunspeetâ Holland
Phone 31-3412-72222

SHIMANO AMERICAN CORPORATION

One Holland Irvine CA 92618 U. S. A.
Phone 949-951-5003

Spare parts list for after market.

- You may photocopy this sheet and use it as an order form.
- Sie können dieses Blatt kopieren und als Bestellformular verwenden.
- Vous pouvez photocopier cette feuille et l'utiliser comme bon de commande.
- Dit blad kan gecopieerd en als bestelformulier gebruikt worden.
- Potete fotocopiare questo foglio e usarlo come modulo di commissione.

SHIMANO 105 Dual Control Lever ST-5500

Dec. 1998

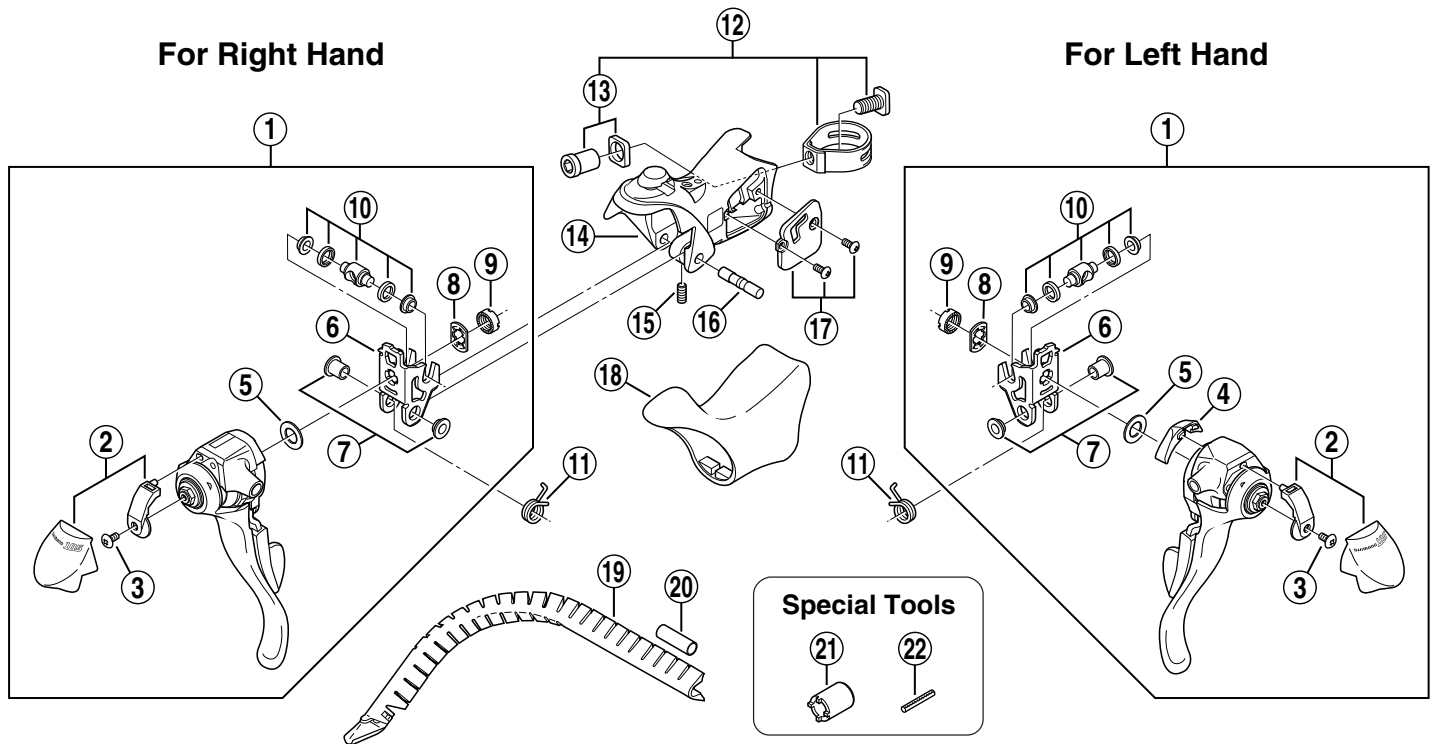

ITEM NO.	SHIMANO CODE NO.	DESCRIPTION
1	3-6B4 98010	R.H. Main Lever Assembly
	3-6B4 98020	L.H. Main Lever Assembly
2	3-6B4 98070	R.H. Name Plate & Front Cover
	3-6B4 98080	L.H. Name Plate & Front Cover
3	4-6BS 42000	Front Cover Fixing Screw (M3 x 6)
4	4-6BS 71100	L.H. Rear Cover
5	4-6BS 74000	Adapter Spacer
6	4-6B4 01000	R.H. Adapter
	4-6B4 51000	L.H. Adapter
7	3-85Z 98010	Lever Axle Bush Unit
8	4-6BD39000	Non-Turn Washer
9	4-66E 33000	Lock Nut
10	3-6BD98110	Cable Hook Unit
11	4-6BD75000	R.H. Return Spring
	4-6BD74000	L.H. Return Spring
12	3-6BD98120	Clamp Band Unit ($\phi 23.8$ mm – $\phi 24.2$ mm)
13	3-6BD98130	Clamp Nut & Washer
14	3-6B4 98030	R.H. Bracket
	3-6B4 98040	L.H. Bracket
15	4-6BD76000	Lever Axle Fixing Screw
16	4-6BS 84000	Lever Axle
17	3-6B4 98050	R.H. Bracket Cap & Fixing Screws (M3 x 6.35)
	3-6B4 98060	L.H. Bracket Cap & Fixing Screws (M3 x 6.35)
18	3-6BS 98090	Bracket Covers (Pair)
19	3-86B 90010	Outer Cable Guide
20	4-877 11000	Outer Cable Joint
21	4-130 03000	Lock Nut Removal Tool (TL-ST01)
22	4-130 03100	Return Spring Installation Tool (TL-ST02)